

## SAFETY WARNINGS

- **DO NOT** drive this scooter over gravel, sand, uneven, loosely packed, and/or rough terrain
- Avoid exposure to rain, sand or standing water whenever possible. Maintain and store in clean and dry condition.
- Turn slowly. Avoid abrupt turns as this may cause tipping.
- Driving in reverse on a flat surface and hitting an object could cause a fall and serious injury
- The max incline for this scooter is eight degrees – **DO NOT** drive on steep slopes.
- Keep your hands away from the tires when driving. Be aware that loose fitting clothing can become caught in the drive tires.
- Do not place scooter in freewheel mode when on an incline or decline.
- Warning! You should not operate your scooter on public streets and roadways. Be aware that it may be difficult for traffic to see you when you are seated on your scooter. Obey all local pedestrian traffic rules. Wait until your path is clear of traffic then proceed with extreme caution.
- Do not attempt to negotiate a curb or stair that has a height greater than 2 inches. Scooters are not designed to travel up or down stairs or escalators. Always use an elevator.

## BATTERIES & CHARGING

### CHARGING THE SCOOTER BATTERIES:

1. Position the scooter close to a standard wall outlet
2. Remove key from key switch
3. Make sure the freewheel lever is in drive (pushed back) position
4. Plug the 3-pin off-board battery charger into the power cord receptacle (located on the battery pack and/or on the tiller (steering column) of the scooter)
5. Extend the charger power cord from the off-board battery charger into the wall outlet
6. When batteries are fully charged, unplug the power cord from the wall outlet and then from the receptacle on the scooter

### BATTERY CONDITION METER

Green =  
Fully  
Charged

Yellow =  
Draining  
Charge

Red =  
Immediate  
Recharge  
Necessary

### HOW LONG DO I CHARGE MY SCOOTER?

1. Charge the scooter overnight for 8-14 hours.

### TO OBTAIN MAXIMUM RANGE PER BATTERY CHARGE:

1. Fully charge batteries before use
2. Plan your route to avoid as many hills as possible
3. Limit baggage weight to only your most essential items
4. Maintain an even speed while in motion; avoid stop-and-go driving
5. A full charge should give a range of approximately eight miles

## SCOOTER SAFETY & USER INFORMATION GUIDE



### MAUI

292 Alamaha St.  
Kahului, HI 96732

Ph: (808) 877-4032

### KAUAI

4490 Puhi Rd. #101  
Lihue, HI 96766

Ph: (808) 632-2333

### OAHU

Pearl Kai Shopping Center  
98-199 Kamehameha Hwy #E4  
Aiea, HI 96701

Ph: (808) 597-8087

M-F 9am-12pm, 1pm-5pm

[www.gammie.com](http://www.gammie.com)

## SCOOTER WEIGHT LIMITS



**GO GO PLUS**  
(3 wheel)  
300 lbs.



**GO GO SPORT**  
(4 wheel)  
325 lbs.



**REVO 2.0**  
(3 or 4 wheel)  
400 lbs.



**VICTORY 10**  
(3 wheel)  
400 lbs.



**MAXIMA**  
(3 wheel)  
500 lbs.

# SAFETY & OPERATION

## BEFORE GETTING ON THE SCOOTER:

1. Make sure key is out of the key switch
2. Make sure freewheel lock is in the drive (pushed back) position
3. Make sure seat is locked into position  
To turn seat:
  - Pull up on seat lever
  - Rotate seat to right or left of desired position
  - Lower seat lever to lock into position
4. Make sure tiller is locked securely in place
  - Turn adjustment knob counterclockwise to loosen tiller
  - Set in comfortable position
  - Turn knob clockwise to lock tiller in position

## OPERATING THE SCOOTER:

1. Insert the key into the key switch
2. Set the speed adjustment dial to your desired speed (tortoise = slow, hare = fast)
3. Press your thumb on the right throttle lever to go forward
4. Press your thumb on the left throttle lever to go backward
5. Pull the left handgrip to steer left
6. Pull on the right handgrip to steer right
7. Release the throttle lever to have the scooter automatically decelerate and stop
8. Park brake automatically engages when the scooter comes to a stop

**IMPORTANT:** Come to a complete stop and remove key from key switch before getting off of the scooter

# DIASSEMBLY & ASSEMBLY

## (ONLY FOR THE GO-GO SERIES SCOOTERS)

**NOTE:** No tools are necessary to disassemble or assemble the Go-Go. Please **DO NOT** attempt to lift a weight beyond your physical capability that may result in injury.

## DIASSEMBLY

1. Remove key and put freewheel lever in the backward (drive) position
2. Lock the front wheel by pushing the tiller lock knob in and turning 90 degrees clockwise
3. Disengage seat lever by pulling up then lift seat straight up to remove from the Go-Go
4. Remove battery pack by using handle and pulling up and away
5. Loosen tiller adjustment knob, lower tiller, retighten tiller knob
6. Lift up on the frame release lever until the frame hooks are no longer resting on the lower frame tube. Slowly separate the two sections of the Go-Go.

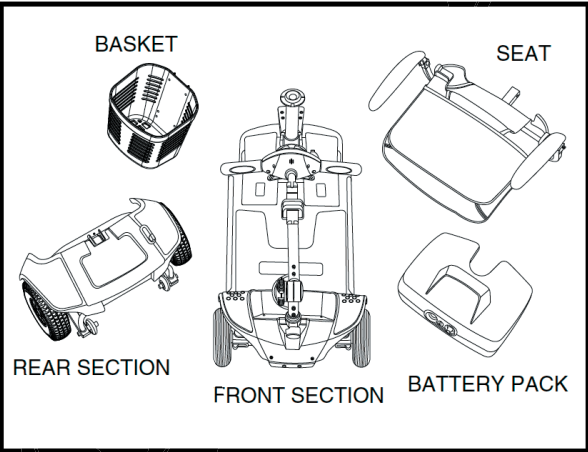

## ASSEMBLY

1. Position front and rear sections just as you took them off. Use the frame release lever to lift the front section as you align the frame hooks of the front section with the lower frame tube of the rear section.
2. Once the frame hooks are over the lower frame tube, lower the front section completely.
3. Loosen tiller adjustment knob, raise tiller, retighten tiller knob
4. Reinstall battery pack. Be sure battery pack connects firmly to battery terminal.
5. Replace seat and rotate until it locks into the correct position
6. Unlock the front wheel by turning the tiller lock knob 90 degrees counterclockwise.

## DIAGNOSTIC BEEP CODES

BEEP CODE	CONDITION	SOLUTION
• 1	Battery voltage is too low to operate the Travel Scooter.	Charge batteries as soon as possible.
•• 2	Battery charge is too low.	Charge batteries.
••• 3	The Travel Scooter's battery voltage is too high to operate the scooter, or the charger is still connected to the off-board charger port.	Unplug charger and/or turn key off, then back on again. If traveling down a slope, reduce Travel Scooter speed to the minimum setting.
•••• 4	Current limit time out.	Turn the Travel Scooter off for a few minutes, then turn your Travel Scooter back on.
••••• 5	The manual freewheel lever is in the (forward) freewheel position.	Remove the key from the key switch, then push the manual freewheel lever to the drive (backward) position and restart your Travel Scooter.
•••••• 6	Throttle control lever not at center position at start up.	Return the throttle control lever to center position, turn Travel Scooter off then back on.
••••••• 7	Speed pot error.	Contact your authorized Pride Provider for assistance.
•••••••• 8	Motor volts error.	Contact your authorized Pride Provider for assistance.
••••••••• 9	Other internal errors.	Contact your authorized Pride Provider for assistance.

# TROUBLESHOOTING

## WHAT IF ALL SYSTEMS ON THE SCOOTER SEEM TO BE “DEAD”?

- Make sure key is fully inserted into key switch
- Make sure batteries are fully charged
- Push in the “reset” main circuit breaker button at the rear of the scooter
- You may have to remove key and reinsert key into key switch
- Ensure battery pack is firmly connected to the battery terminals

## WHAT IF THE MOTOR RUNS BUT THE SCOOTER DOESN'T MOVE?

- The scooter may be in freewheel mode
- Make sure the freewheel lever at the rear of the scooter is pushed down
- What if the main circuit breaker repeatedly trips?
- Avoid steep hills—they can cause batteries to overload and trip circuit
- If the problem persists, please call Gammie HomeCare

## WHAT IF THE SCOOTERS BATTERIES WON'T CHARGE?

- Be sure battery cables are connected
- Be sure both ends of the charger cord are inserted fully
- Switch to a different wall outlet

## Power Down Timer Feature

- Your scooter may automatically shut-down if the key is left in the “on” position and no activity has occurred for 20 minutes.
- To resume normal operation, turn key to the “off” position and then again to the “on” position